

Social Problems

**Lost Time Driving / Car and Bus Unsuitable
for working and living comfortably**

quality of life & productivity lost



\$422 Billion
in working
hours



Source: Morgan Stanley Research

Introducing the Future

- NEXT Future Transportation is an advanced, autonomous, modular, **scalable mass transit** system
- The NEXT modules are autonomous and can be used to **pick and drop off passengers**
- The NEXT modules also **assemble** themselves into “**bus-trains**”, to transit longer distances on the freeway
- Consequently, NEXT achieves the golden solution: **customized** last mile, and **optimized** transit on the freeway segments

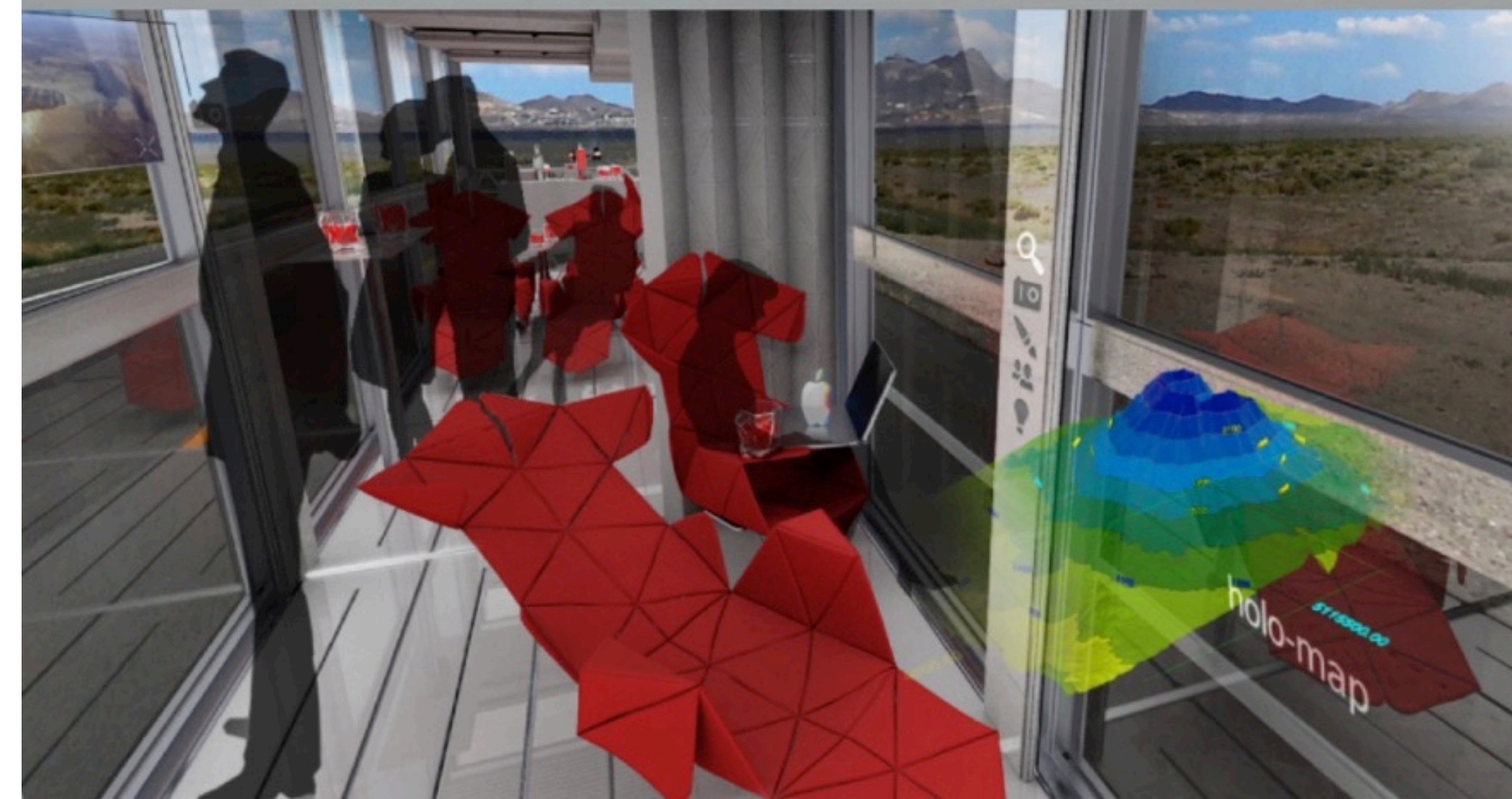

2017

Hybrid **Scalable** System

2021

Human Driving

Upgrade

Complete Self-Driving

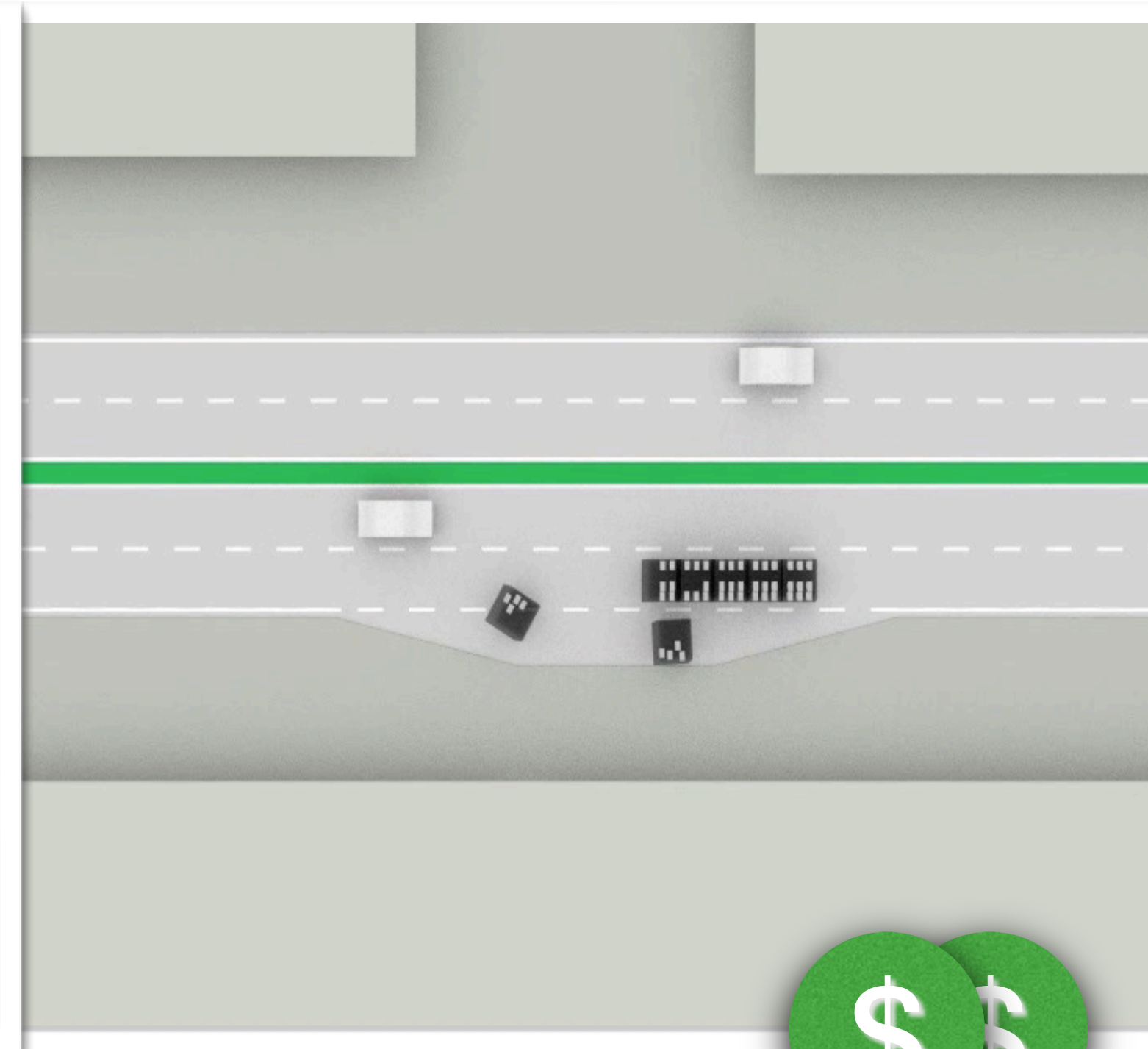

Sell NEXT Modules Fleets

- Sell Fleet of modules to University **Campus**
- Sell Fleet to modules Innovative **Municipalities** (already in contact with Bad Hersfeld in Germany and Vilnius in Lithuania)

Modular Fleet Optimization

- Autonomous **private modules selling**
- Gradual bus fleet replacement with modular NEXT buses
- **Revenues** from **Fleet Selling** and **Upgrading**

On-Demand Services

- On-demand mobility
- Third party services modules
- **Revenues** from 30% of transactions via Next app: **ticketing, on-demand call and services.**

Competitors Comparison

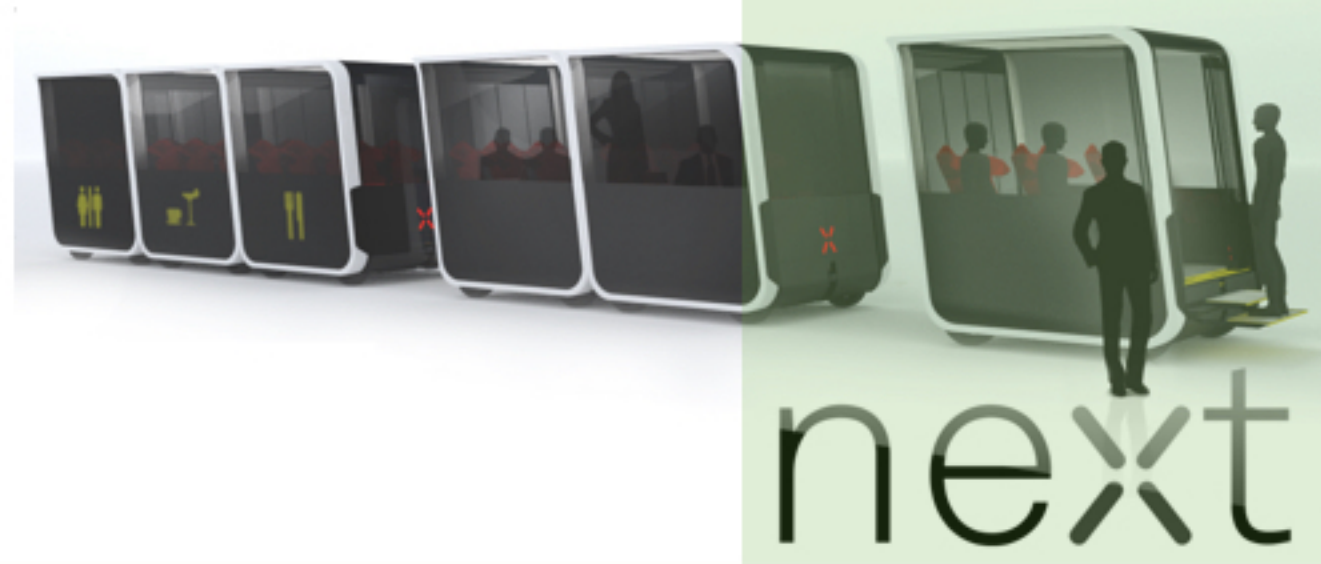

Self-Driving Car



Modular Pods



Self-Driving Bus

	next	Self-Driving Car	Modular Pods	Self-Driving Bus
Average Occupancy Rate	75%	55%	100%	35%
Traffic Footprint	54 ft	197 ft	123 ft	40 ft
Total Cost per Passenger per km <small>estimations for medium traffic scenario</small>	\$0.08	\$0.07	\$0.06	\$0.20

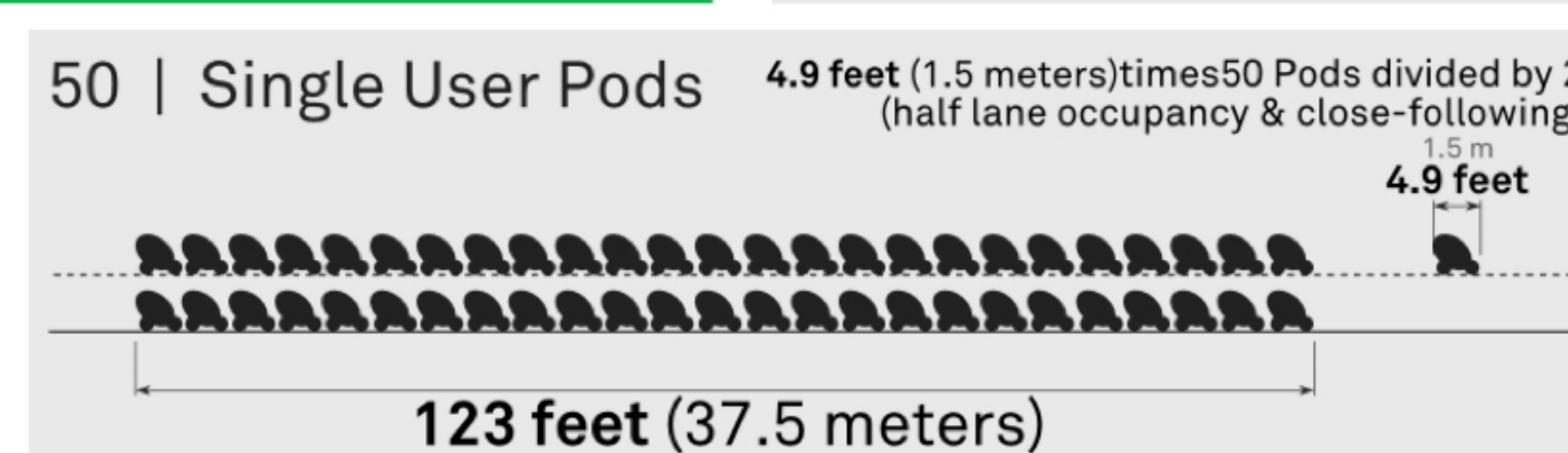
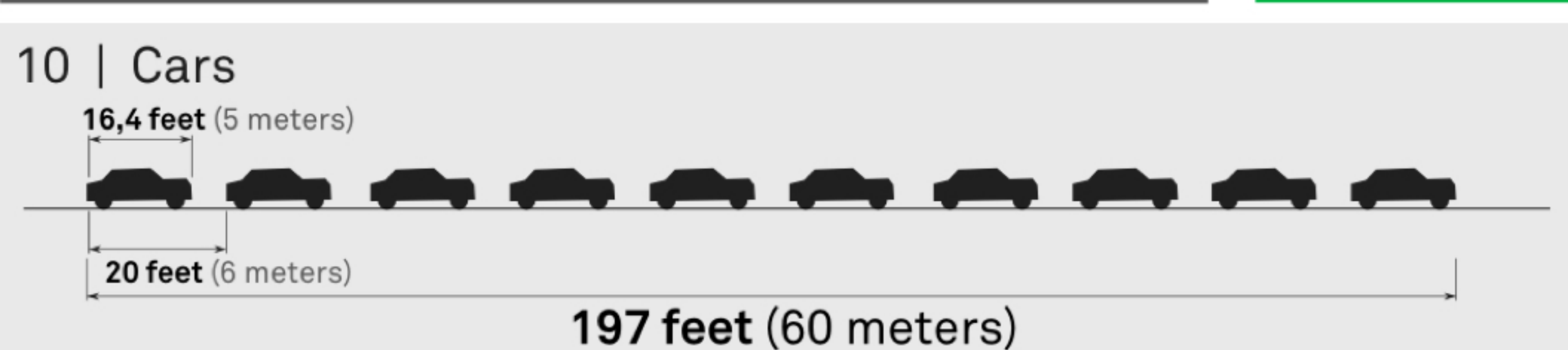
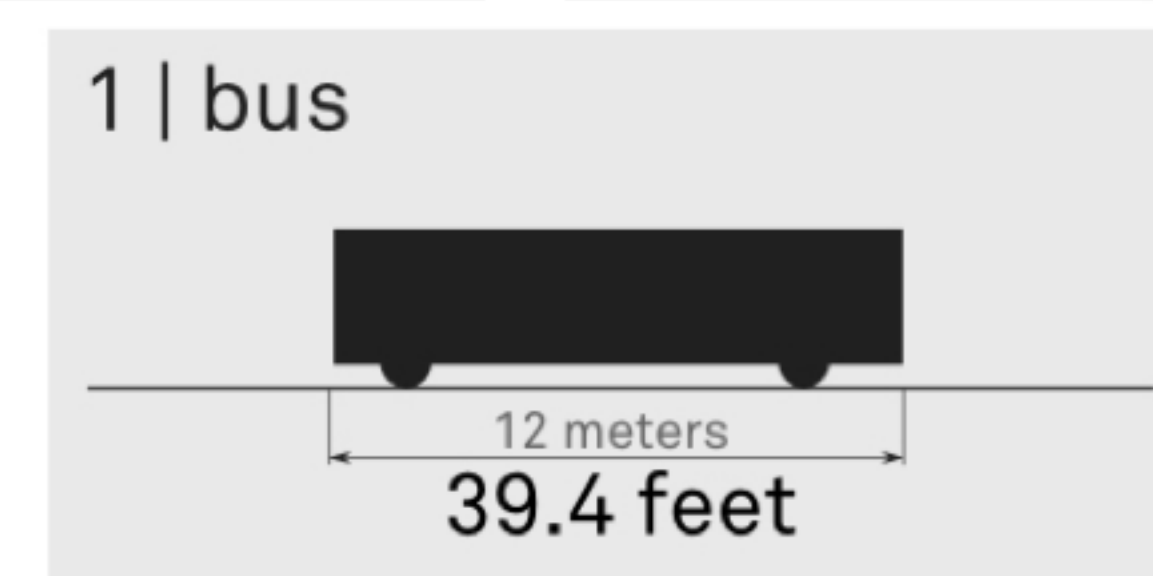
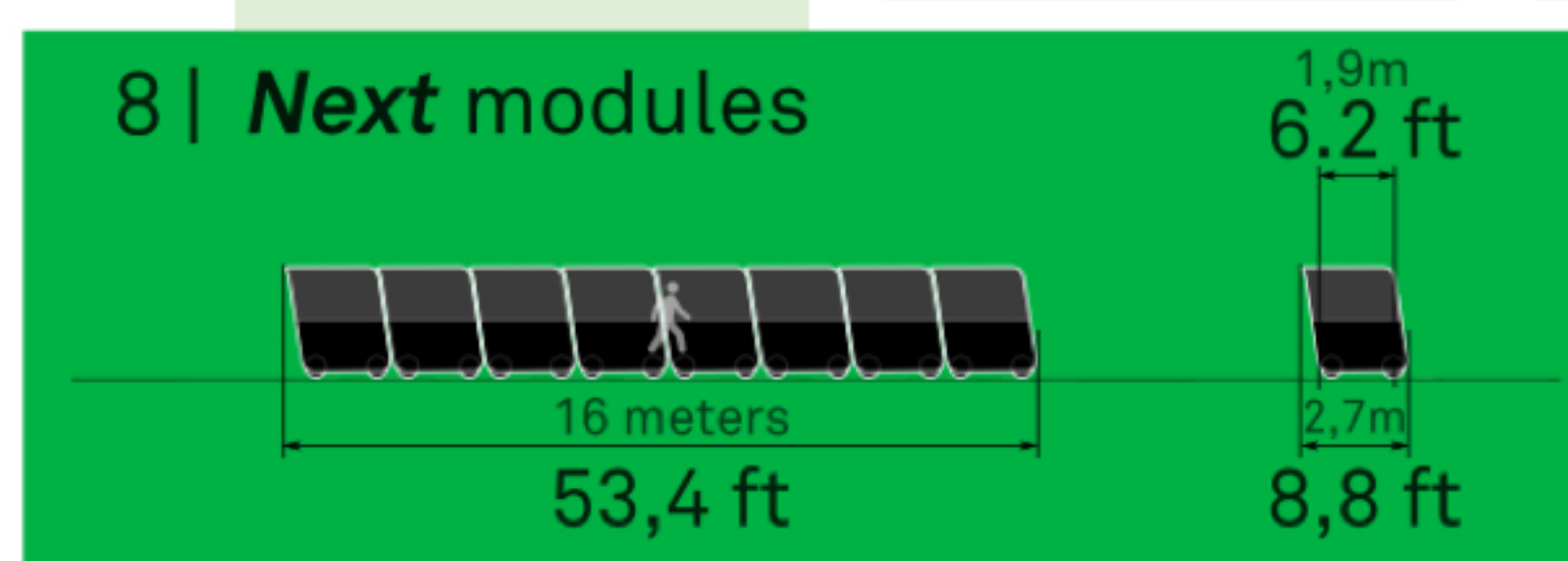

Competitors Comparison

Next offers the best of both worlds:

- Traffic Efficient as a bus during rush hours
- Ubiquitous and Fuel Efficient as shared taxi during low-medium traffic

rush hours

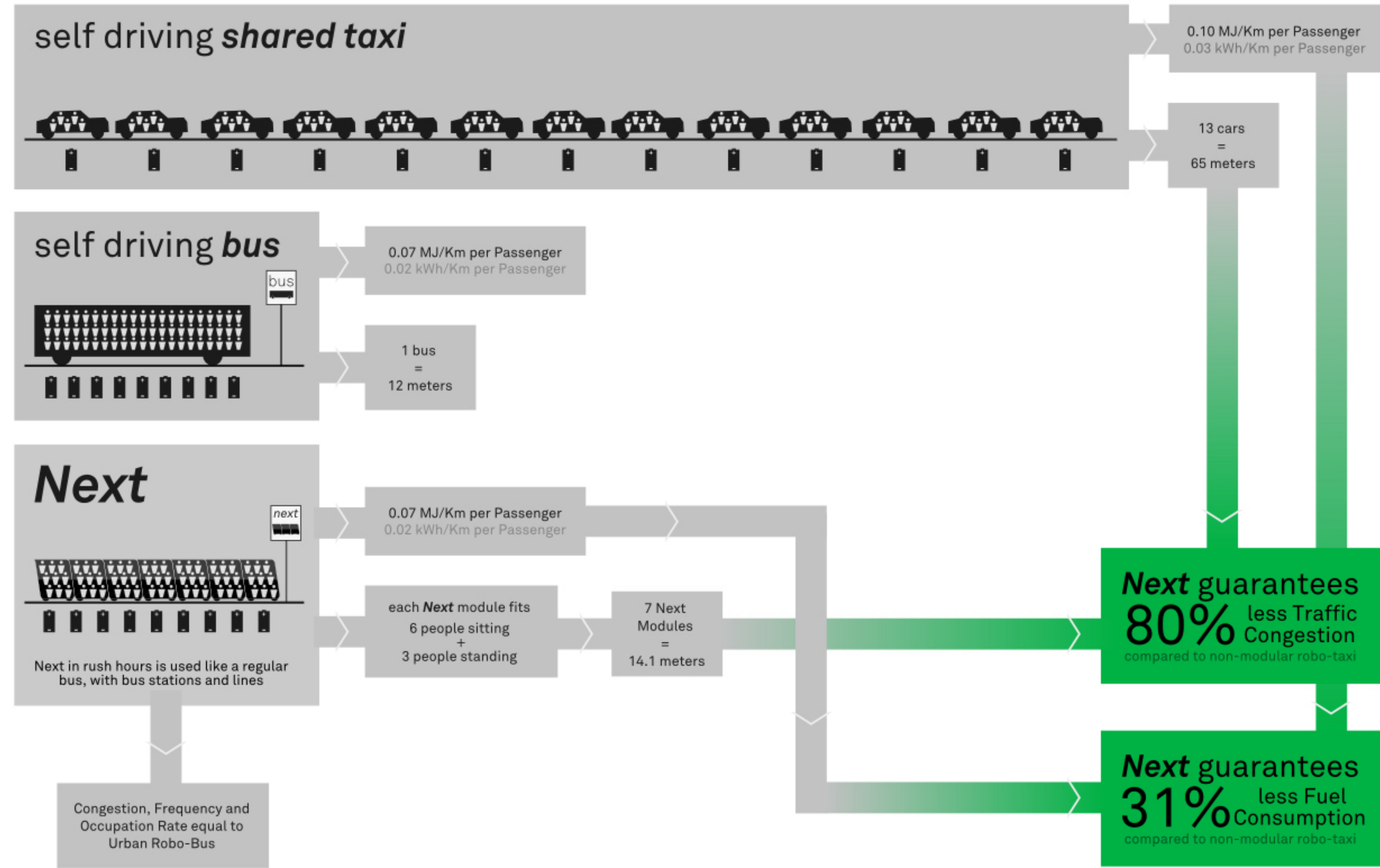
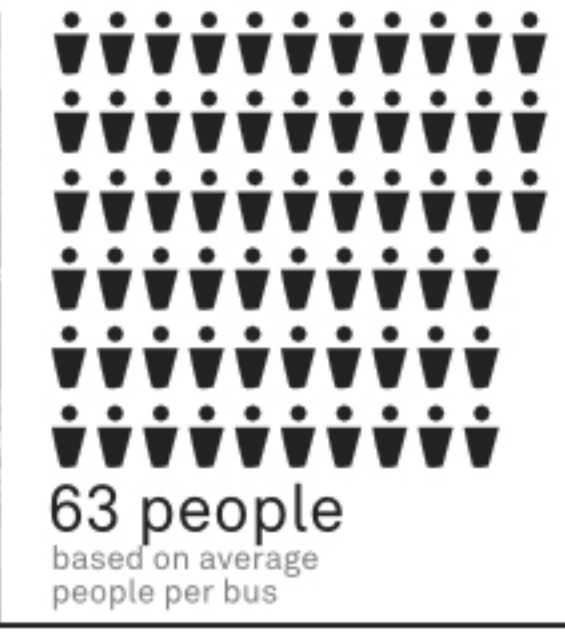
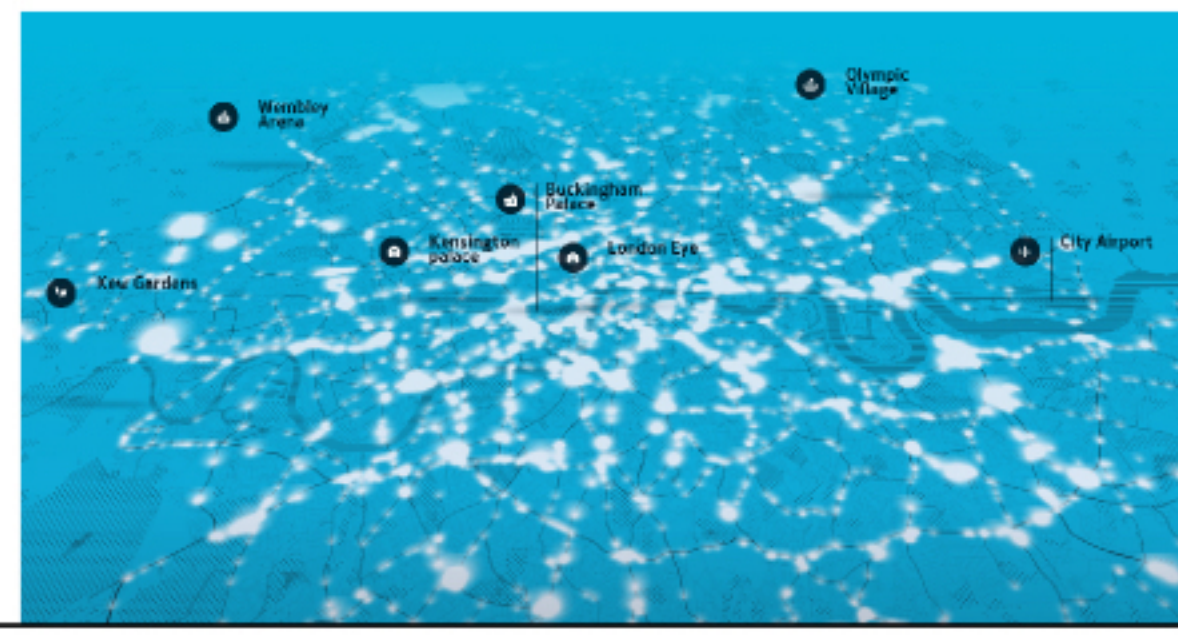
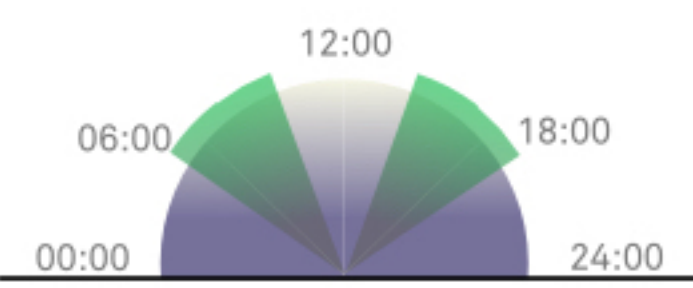

Competitors Comparison

Next offers the best of both worlds:

- Traffic Efficient as a bus during rush hours
- Ubiquitous and Fuel Efficient as shared taxi during low-medium traffic

medium traffic

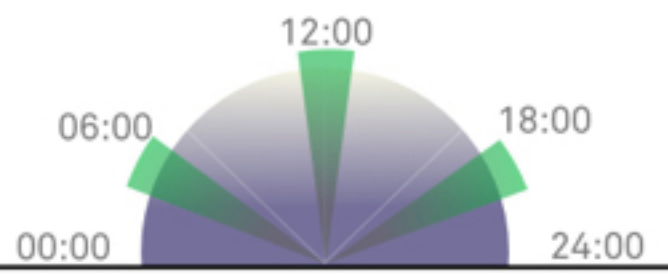

9 people
based on average
people per bus

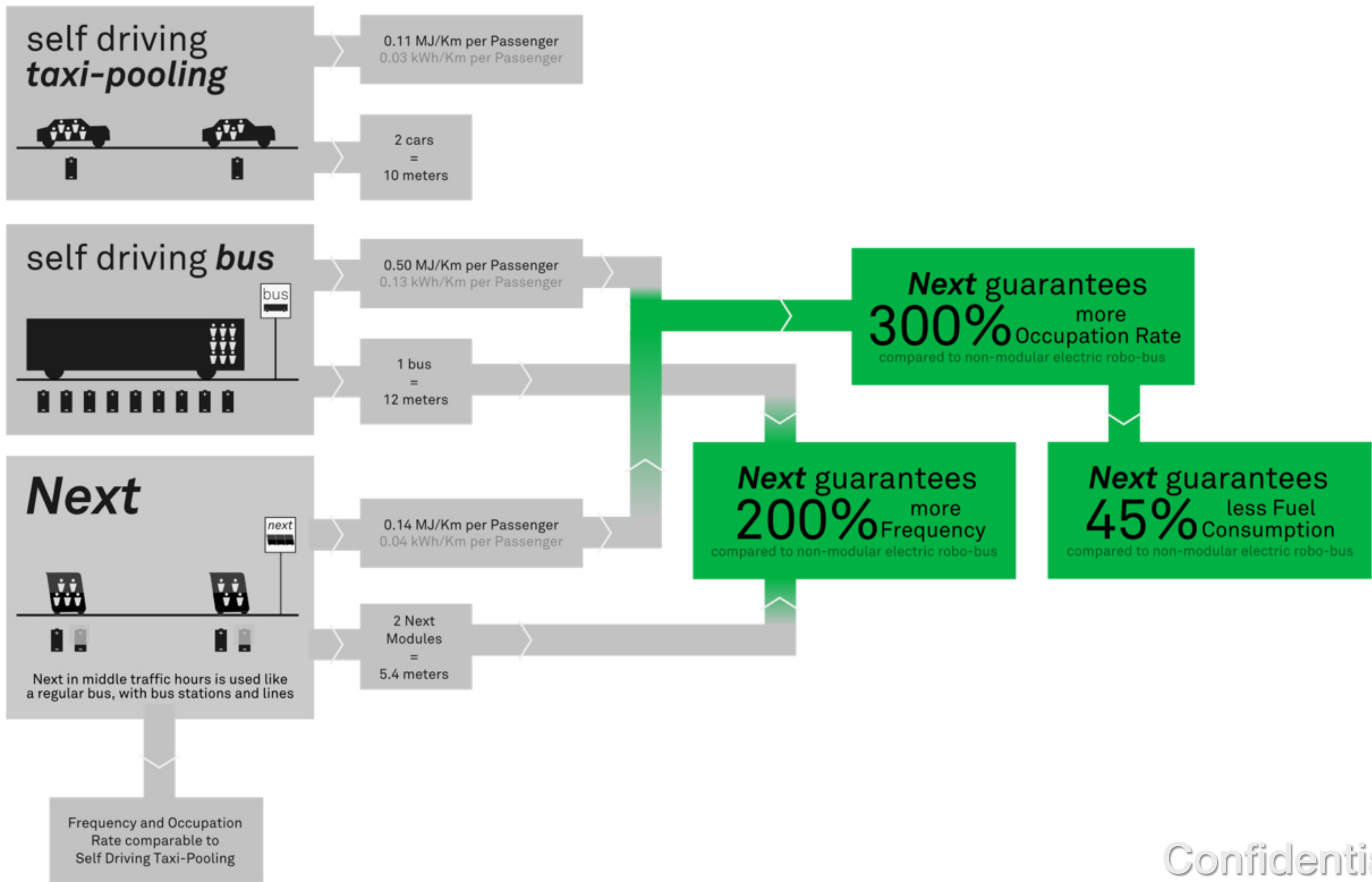

Competitors Comparison

Next offers the best of both worlds:

- Traffic Efficient as a bus during rush hours
- Ubiquitous and Fuel Efficient as shared taxi during low-medium traffic

low traffic

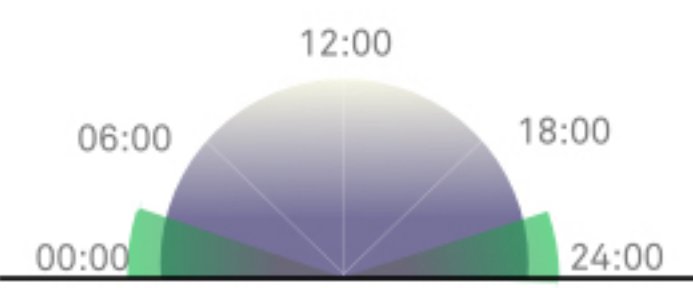

2 people
based on average
people per bus

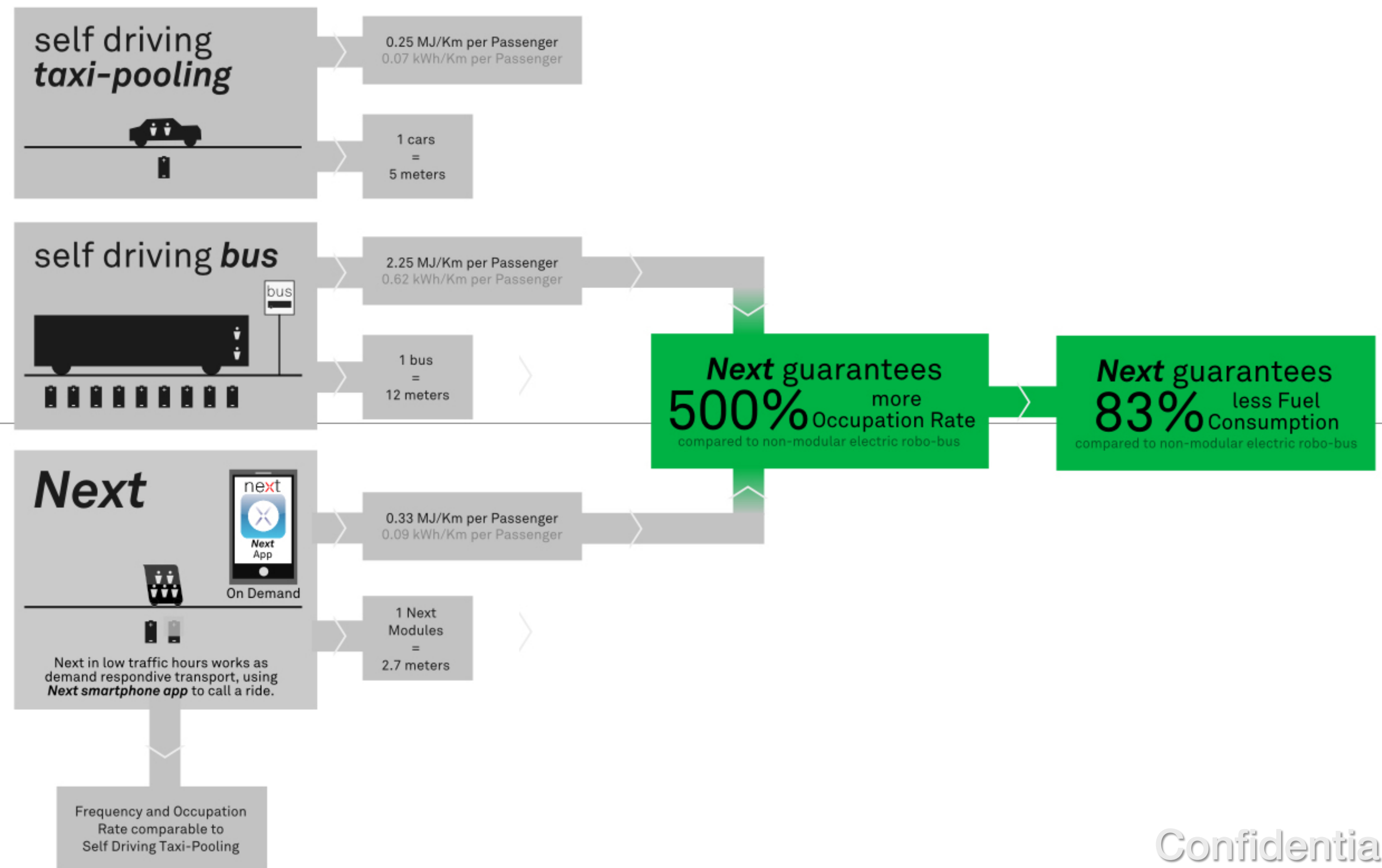

Bay Area Example

City Center Delivery

San Francisco

Urban
Less Traffic
Less Consumption

Users All in One Module

Freed modules go to other requests

Filled modules go on HOV lane

Multiple Modules Join and Passengers Transfer to a Single Module

On Demand Single User Local Picking

Passengers go to head module

Local Pickup

No Stops
No Waiting Time
Suburban

Local Pickup

Local Pickup

Mountain View

